

INSTALLATION, MAINTENANCE and USER`S MANUAL **TOD, TODC, TOX and TOXC.**

Before starting the installation, read the entire Installation
Instruction carefully!!!

1 INSPECT THE INSTALLATION KIT!

The installation kit includes:

- 6tk Clamps (Fig. 1)
- 1 tk Protective tape for truck bed
- 2 tk L-fastener to the front (Fig. 2)
- 2 tk Self-swiveling screw
- 2 tk Screw M6S M5*12
- 2 tk Base plate M5
- 0,7 m Rubber moulding
- 2tk Nut M5
- 2tk Truck bed side middle fastener
- 4tk Staple
- 2tk Jam nut M5
- 2tk Square base plate to the front fastener
- 2tk Headless screw to the front fastener

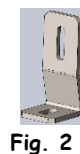

2 START INSTALLING THE HARDTOP ONTO THE TRUCK BED.

Clean first the truck bed side frame and place the transparent protective tape to truck bed side as well to tailgate, (Fig. 3) where back hatch sealing touches the car tailgate.

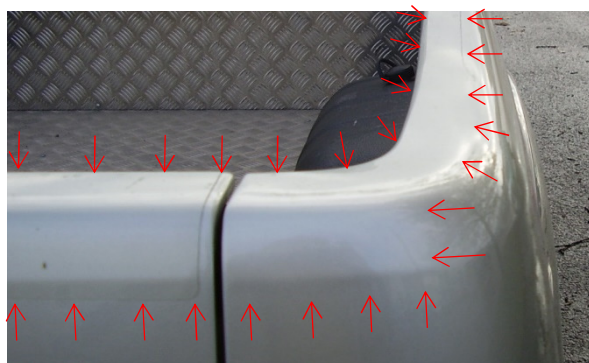
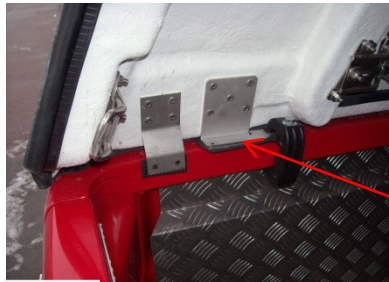

Fig. 3

Glue the rubber moulding (Fig. 4) to the bottom of fasteners before the cap is lifted into place in order to decrease the risk of wear and tear on the frame.



Rubber moulding

Fig. 4



Fig. 5

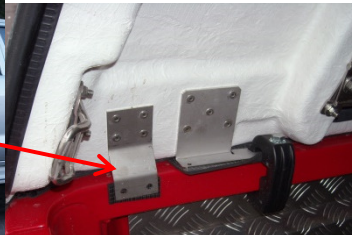

Fig. 6

Lift the cover in place on the car (Fig. 5) at the same time check that the posterior guiding plates (Fig. 6) are not rubbing against the truck bed side, when the cap descends; it may be necessary to bend the plates somewhat.

3 ATTACH THE HARDTOP TO TRUCK BED

Pull the cover backwards on top of the vehicle (Fig. 8) so that it will not rub against the cabin in the front. Place the posterior fasteners to the place of installation as in the picture (Fig. 9) by pressing the cap from the outside towards the truck bed and simultaneously fastening the fasteners. **NOTE! Tension force Max. 10 Nm or 1kg/m.**



Fig. 8



Fig. 9



Fig. 7

Do the same with the front fastener. (Fig. 7)

NOTE! Tension force Max. 10 Nm or 1kg/m.

Caps, equipped with side hatches, are installed with angle fasteners (Fig. 11). Attach the self-adhesive rubber moulding to the lower bar of the enforcement and place it on top of the truck bed side frame in the middle of the hatch opening. Press the cap gently inwards and down towards the vehicle and mark the places of staples to the cap. Drill and staple the enforcement into place with staples from outside. Place then the plastic connector as in the picture and

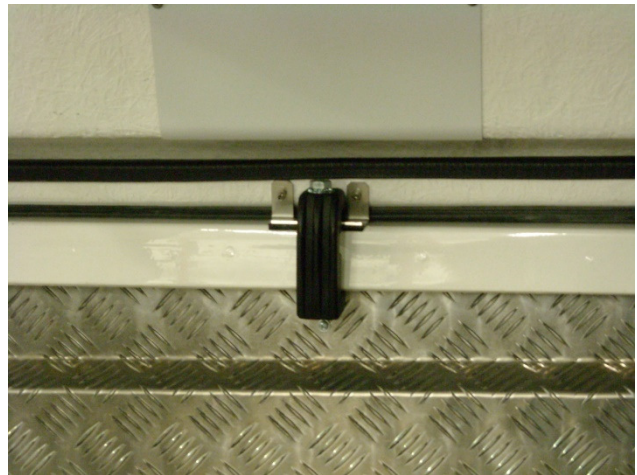

Fig. 11

close.
NOTE! Tension force Max. 10 Nm or 1kg/m.



Fig. 10

If over rail plastic bedliner (Fig. 10) is used it is necessary to drill holes for the clamps.

4 Fasten front mounts!

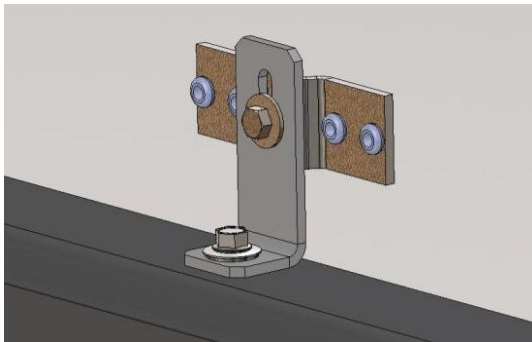

Fig. 12

Vehicles, without a cab protection frame!

Attach the front mounts acc. to the image (Fig. 12). Place the front mount towards the front side and screw it into the existing cover fitting. Using the front mount pull the front backwards and at the same time at mark the load bin's front side for the hole where the self-tapping screws will be drilled. Drill the hole 4,9 - 5,0 mm into the front and tighten the screw.

Vehicles, with a cab protection frame!

Install the front mounting acc. to the image (Fig. 13). Headless screw and nut are manually screwed to metal connector of the cap and fastened as well as possible. Following this mount the big squared base plate and jam nut. Fasten all parts.



Fig. 13

5 ADJUSTING THE HATCHES

TODC, TOXC -0055; -1155; -1133

Check that the doors close easily and that the lock is correctly adjusted, if necessary adjust the lock or locking strap. (Fig. 14)



Fig. 14

It is possible to adjust the length of the locking rods by loosening the plastic clip and turning the locking rod which is screwed into the joint against the locking hook. (Fig. 15)



Fig. 15

TOD, TOX -0055, -1155; -900; -1100

Check that the doors close easily and that the locks are correctly adjusted. If necessary, the height of the glide angle can be adjusted. (Fig. 16)



Fig. 16

6 MAINTENANCE

- ✚ To ensure that the door lock system's moving parts function correctly, lock systems should be lubricated at least twice per year. Under difficult conditions such as a dusty environment, then every month is recommended.
- ✚ Seals should be occasionally lubricated with silicone grease.
- ✚ Our recommendation is to wax the hardtop with gel coat surface when new, mounted on the vehicle, and then annually to avoid discoloration. Read more: "Maintenance instructions for a hardtop with gel coat surface".
- ✚ A pressure washer can be used to wash the inside of the hardtop.
NB!!! Beware of electrical appendices!
- ✚ **NB!!! It is not allowed to step on to the roof!**
- ✚ **NB!!! Check the wear level of the protective tape for tailgate regularly and replace if needed!!!**
- ✚ **NB!!! After driving for approximately 6-8 months all connections should be checked and re-tightened, if necessary!!!**